

1POF90

DESCRIZIONE Piano cottura Officina incasso e filo da 90 - 4 gas + tripla corona
DESCRIPTION 90 cm Officina built-in and flush hob - 4 gas burners + triple ring

PESO LORDO 23.1 Kg
GROSS WEIGHT

DIMENSIONI IMBALLO 925x570x160 mm
PACKAGING DIMENSIONS

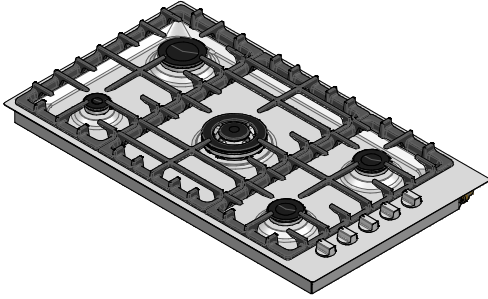

Griglie in ghisa
 Cast iron pan supports

- (A) BRUCIATORE RAPIDO 3 kW RAPID BURNER
- (B) BRUCIATORE AUSILIARIO 1 kW AUXILIARY BURNER
- (C) BRUCIATORE TRIPLA CORONA 3.6 kW TRIPLE RING BURNER
- (D) BRUCIATORE SEMIRAPIDO 1.75 kW SEMIRAPID BURNER
- (E) BRUCIATORE SEMIRAPIDO 1.75 kW SEMIRAPID BURNER
- (F) ALLACCIAMENTO ELETTRICO ELECTRICAL CONNECTION
- (G) CONNESSIONE GAS GAS CONNECTION

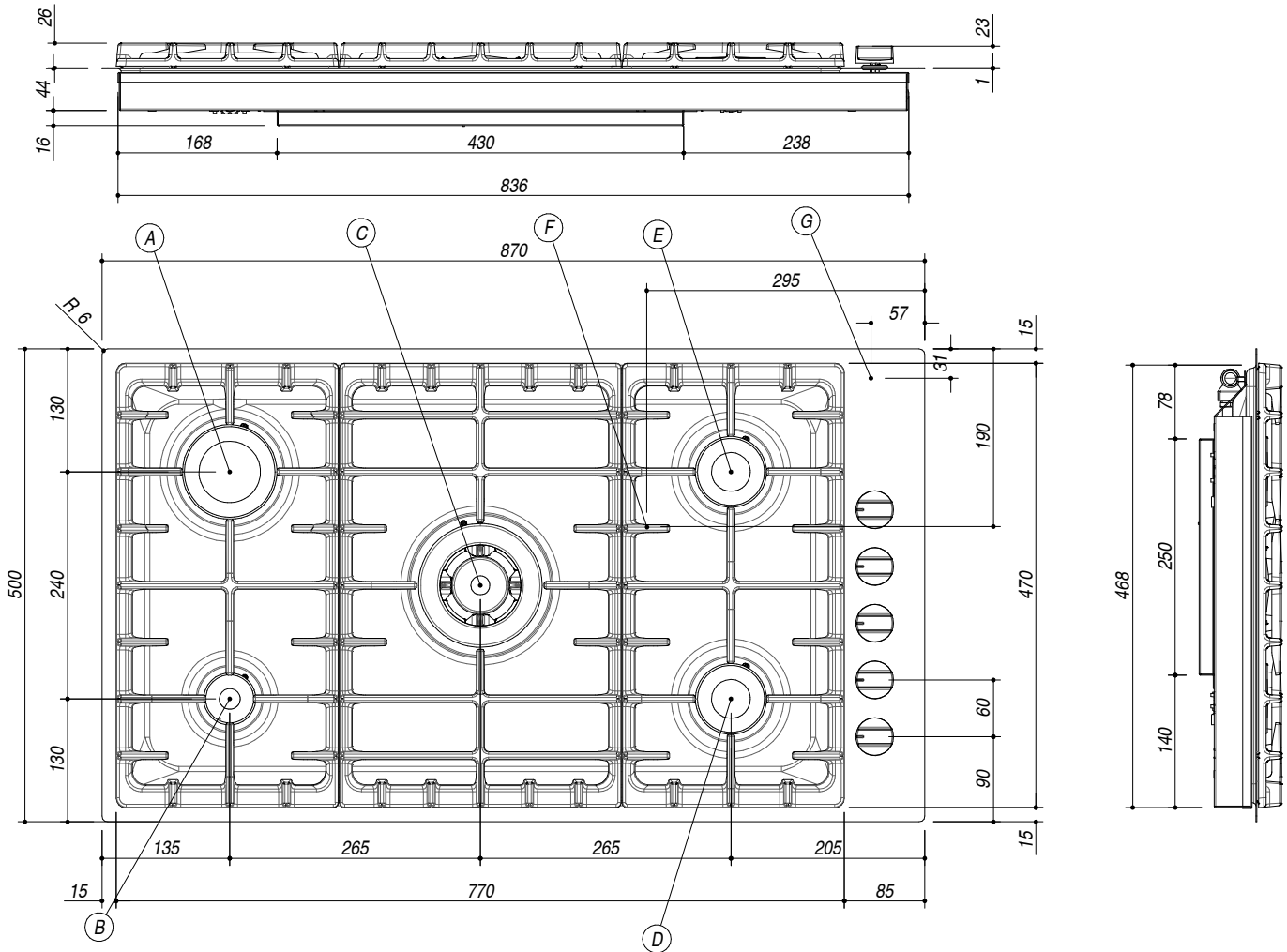

SCALA DISEGNO 1:7.5
DRAWING SCALE

TUTTE LE MISURE IN mm
ALL MEASURES IN mm

TOLLERANZA LINEARE: ± 0.5 mm
LINEAR TOLERANCE

TOLLERANZA ANGOLARE: ± 0.2 °
ANGULAR TOLERANCE

FORATURA PER INSTALLAZIONE AD INCASSO
BUILT-IN CUTOUT FOR TOP

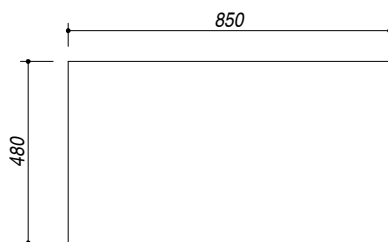

1:20

FORATURA PER INSTALLAZIONE A FILO
FLUSH CUTOUT FOR TOP

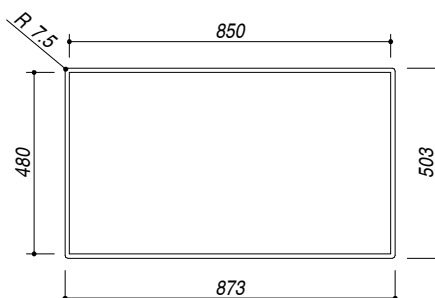

1:20

ABBASSAMENTO
LOWERING

